

SECTION A-A

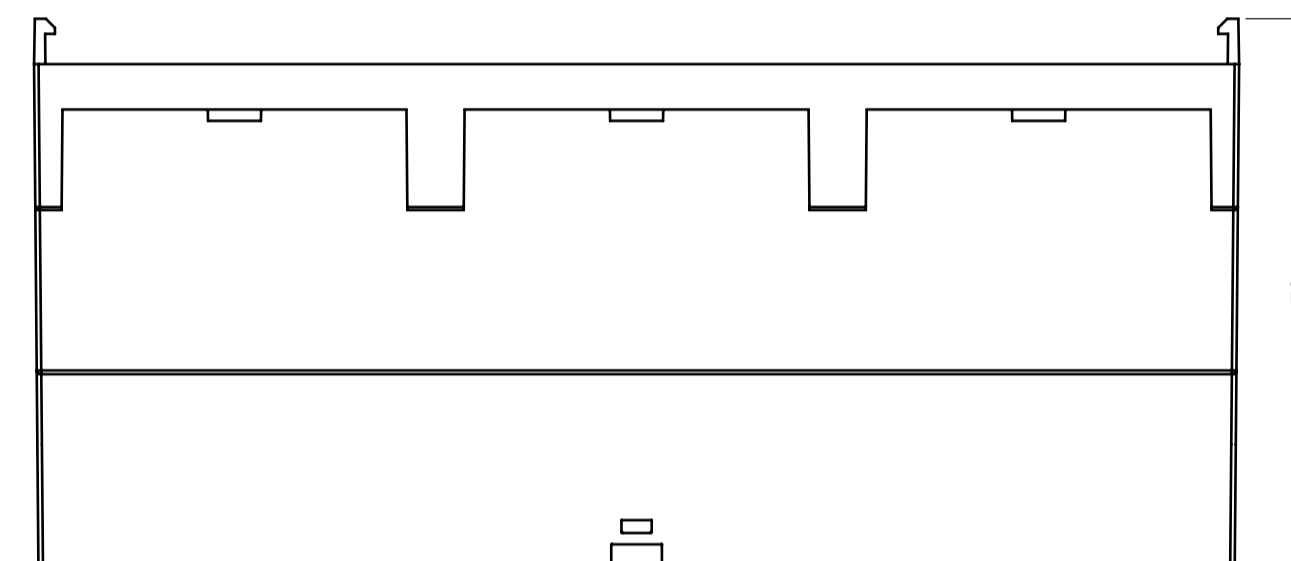

BODY ENCLOSURE

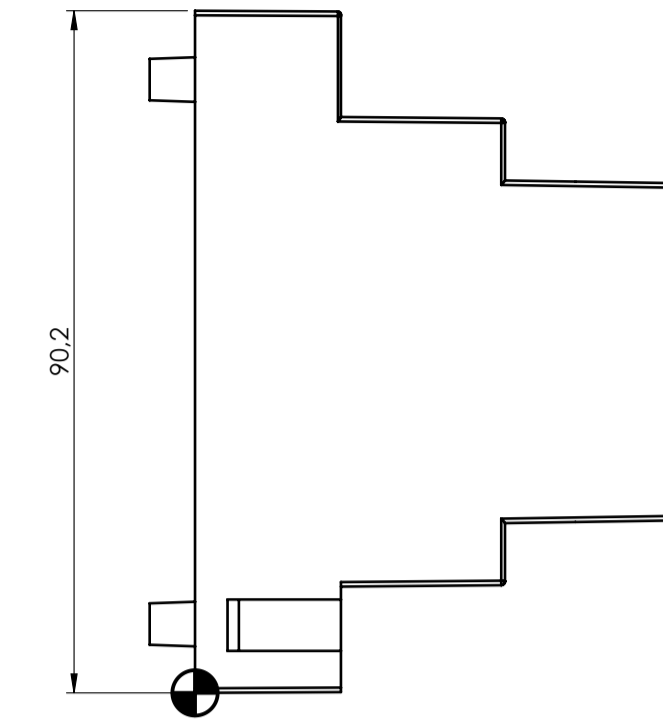
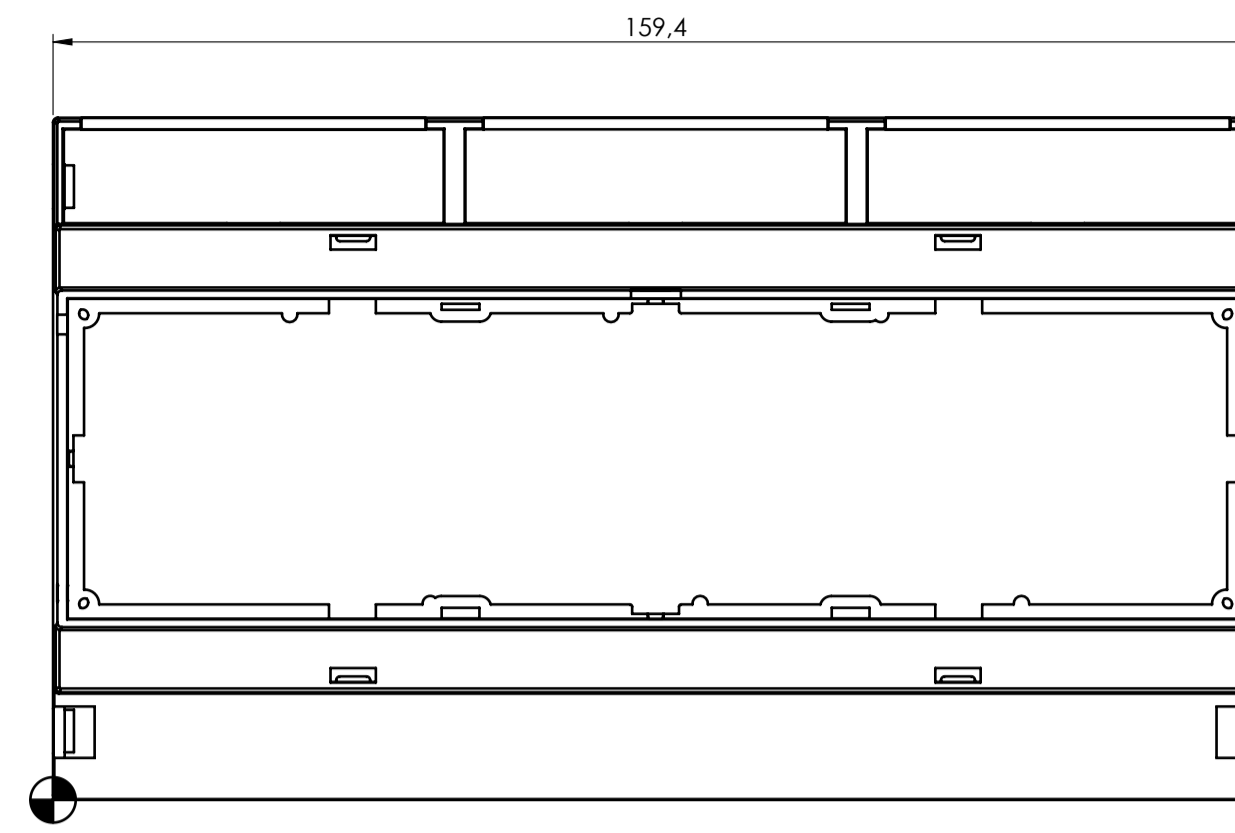
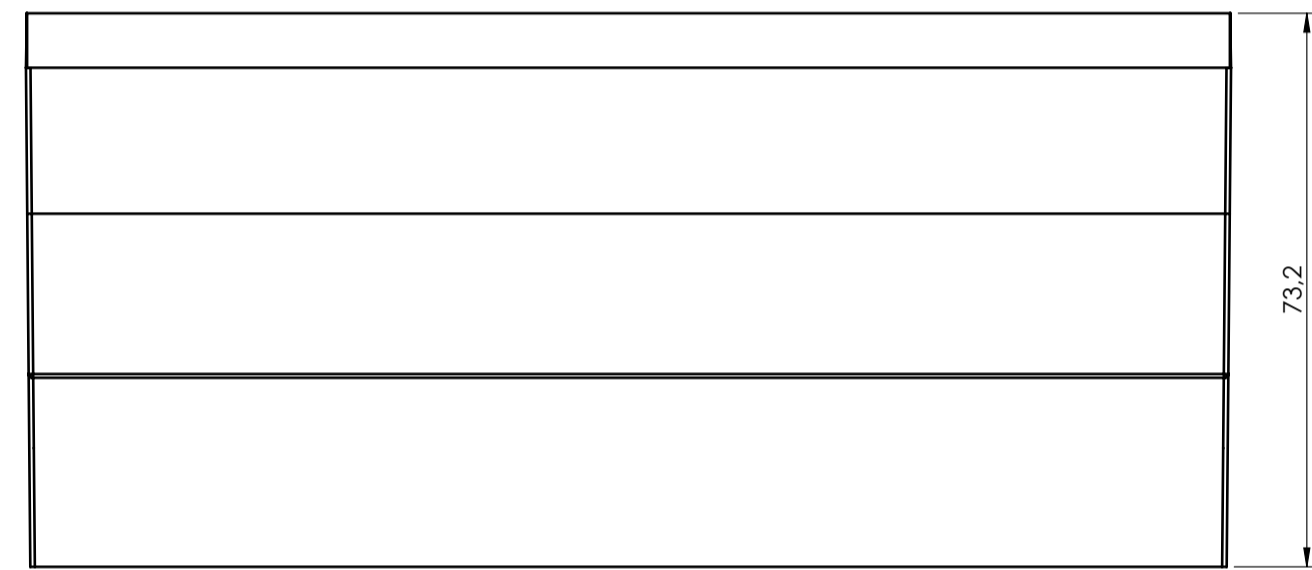
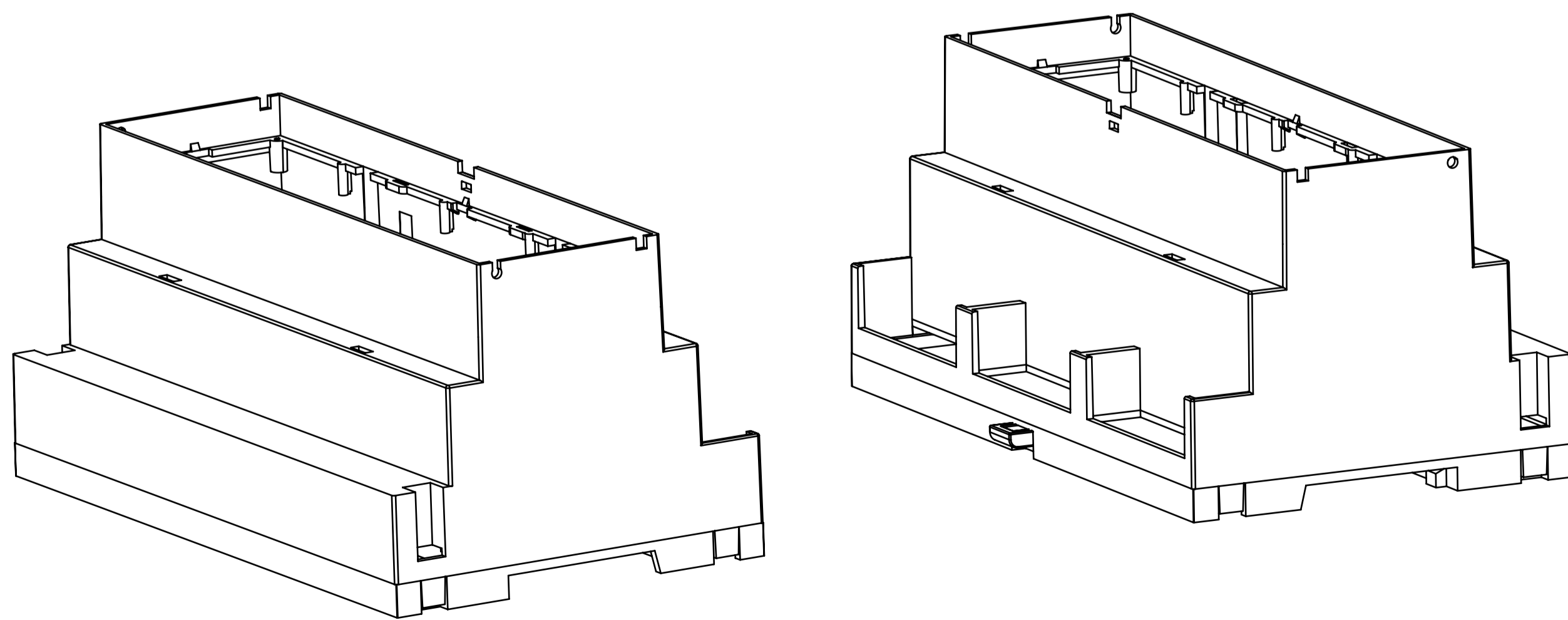
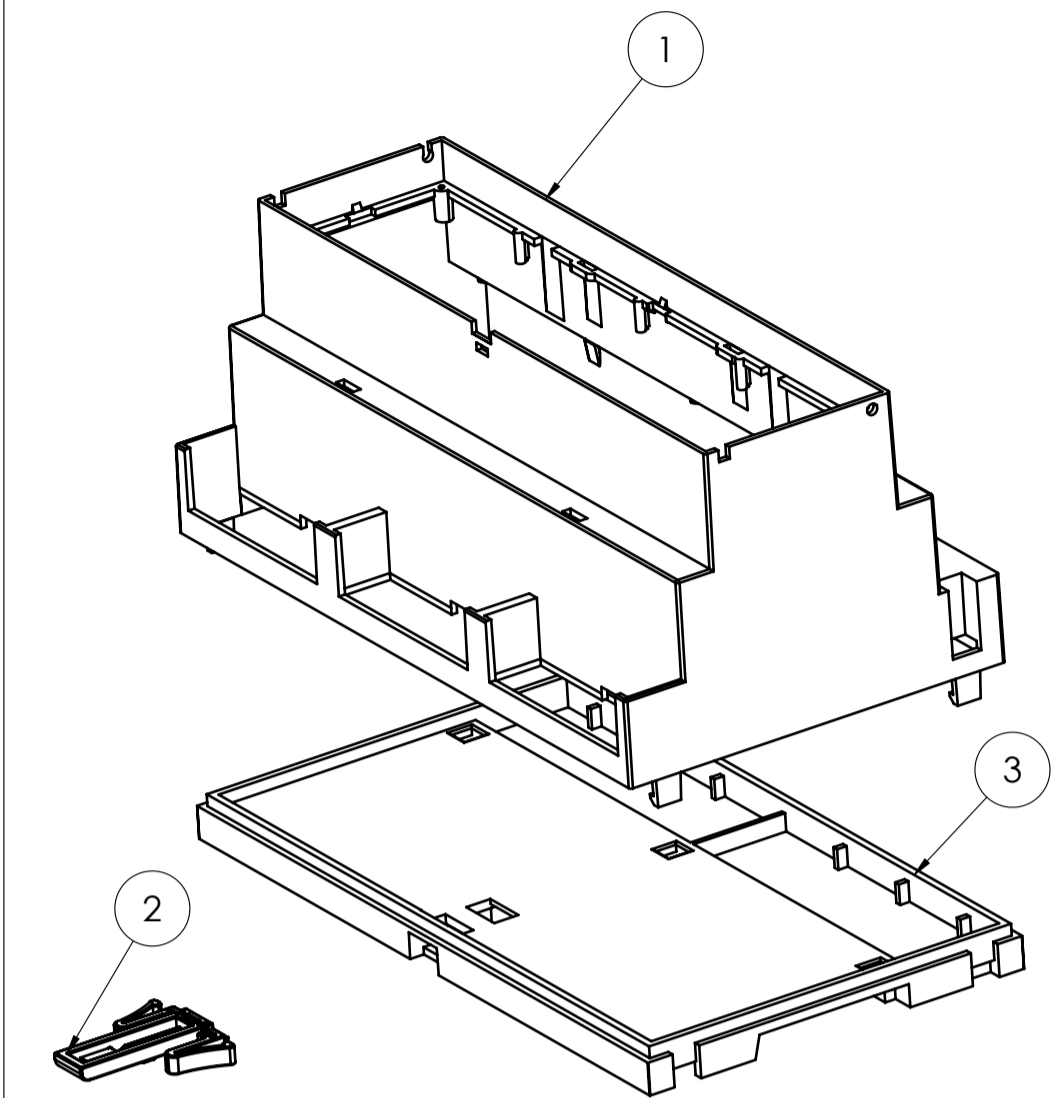

BASE

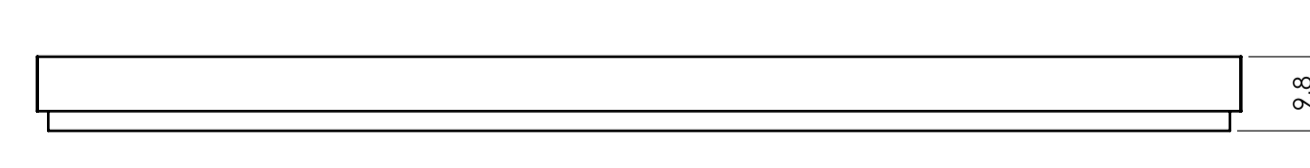
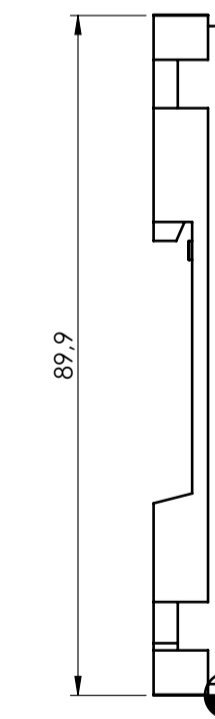
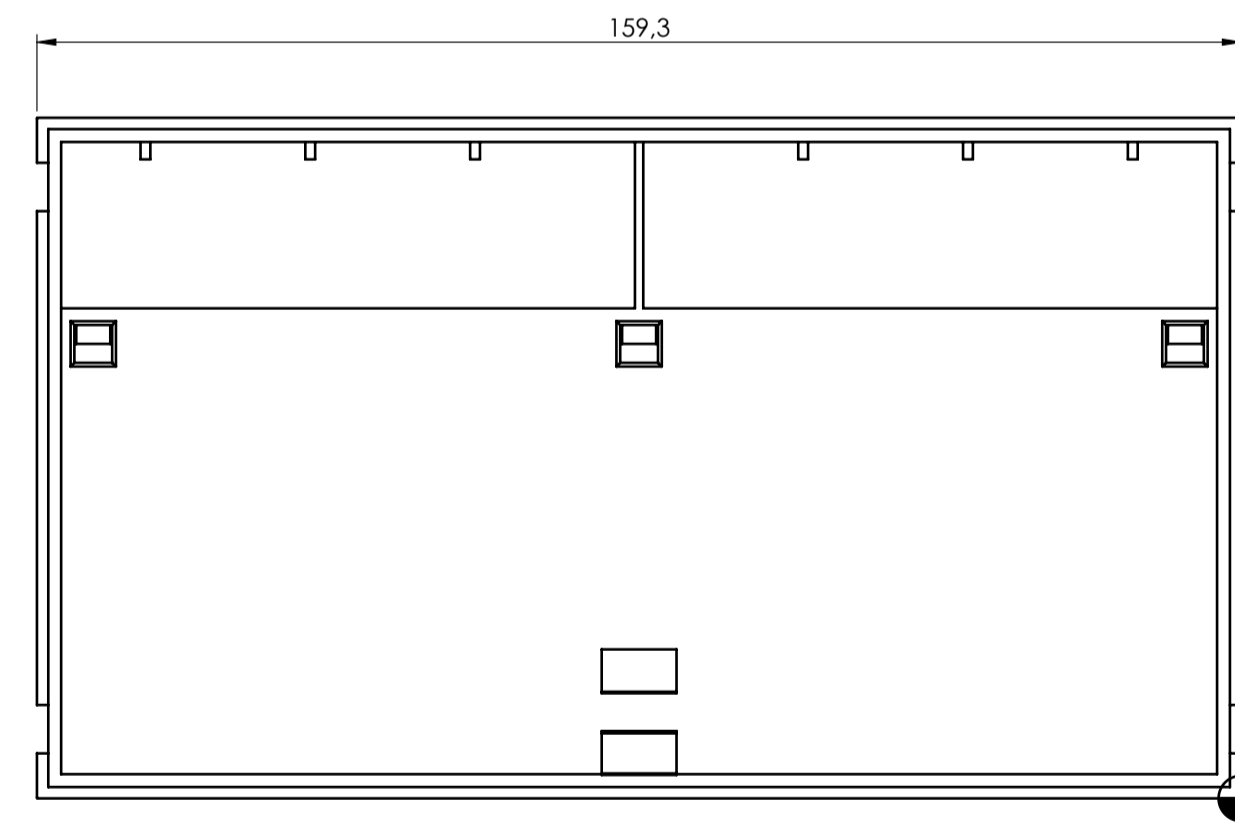

HOOK

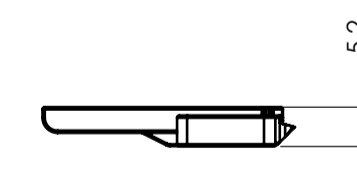
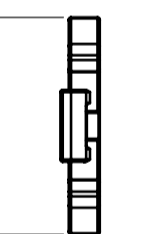
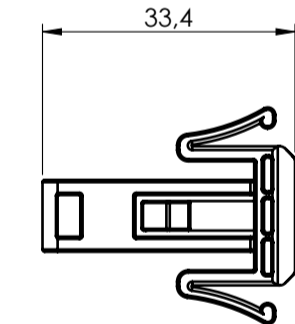

General information:
 ● Workpiece zero point for mechanical processing
 - Minimum recommended radius for machining = R1.0 mm
 - Mounting rail like EN 60715: TH 35-7.5 or TH 35-15
 - Recommended PCB outline on www.italtronic.com

RIF.	Q.TY	DRAWING	DESCRIPTION
1	1	2_250_00197	BODY ENCLOSURE MODULBOX ONE 9MH68
2	1	2_250_00079	HOOK FOR MODULBOX ONE
3	1	2_250_00192	BASE MODULBOX ONE 9M

General Tolerances UNE EN 12768/1 (Media 9M)

from 0.5 to 3 ± 0.1	from 3 to 6 ± 0.1	from 6 to 30 ± 0.2	from 30 to 120 ± 0.3	from 120 to 400 ± 0.5	Sheet: 1
------------------------	----------------------	-----------------------	-------------------------	--------------------------	-------------

Scale: 1:1
 Drawn: M.S.
 Checked: R.N.
 Date: 26/07/2023
 Material:
 Process:
 Dimension in mm: ---
 Weight: gr
 Cod. Mold: ---

Description:
 KIT CONTENITORE MODULBOX ONE 9MH68
 KIT ENCLOSURE MODULBOX ONE 9MH68
 Drawing n°: **3_250_00173**
 Rev: 00 A1
 italtronic.com

PCB A

Max height of the terminal:
Modulbox ONE: 20 mm

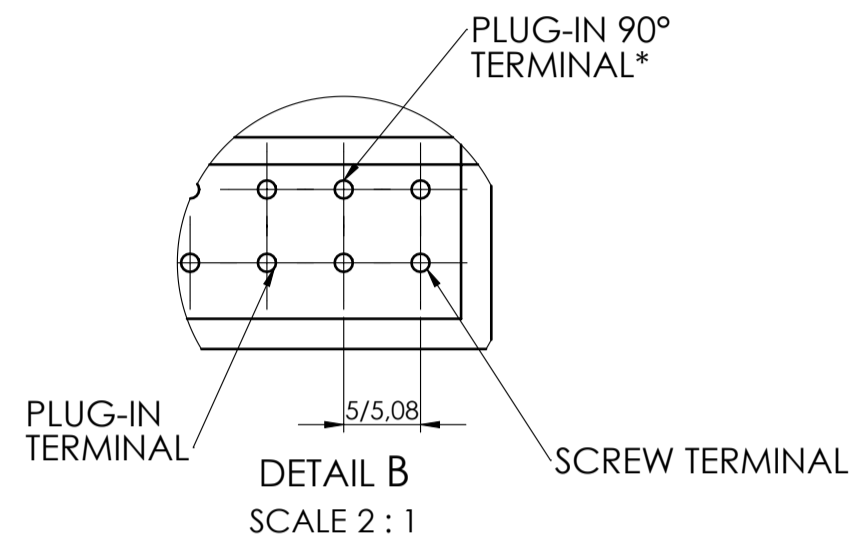
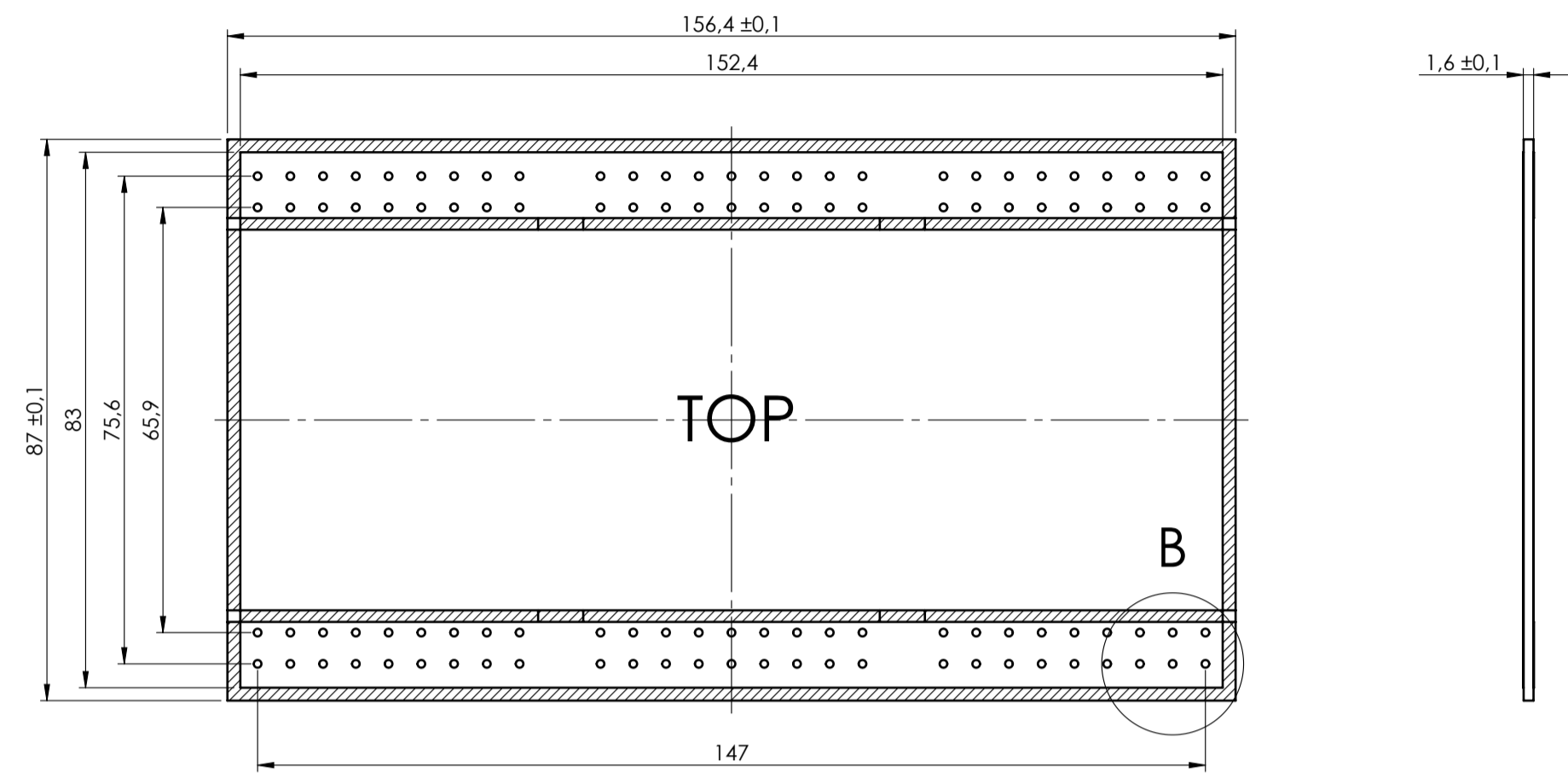

*To use the PLUG-IN terminals in Modulbox ONE use plug-in adapter P05000003E (5/5.08 pitch) and P05000004E (7.5/7.62 pitch)

PCB B

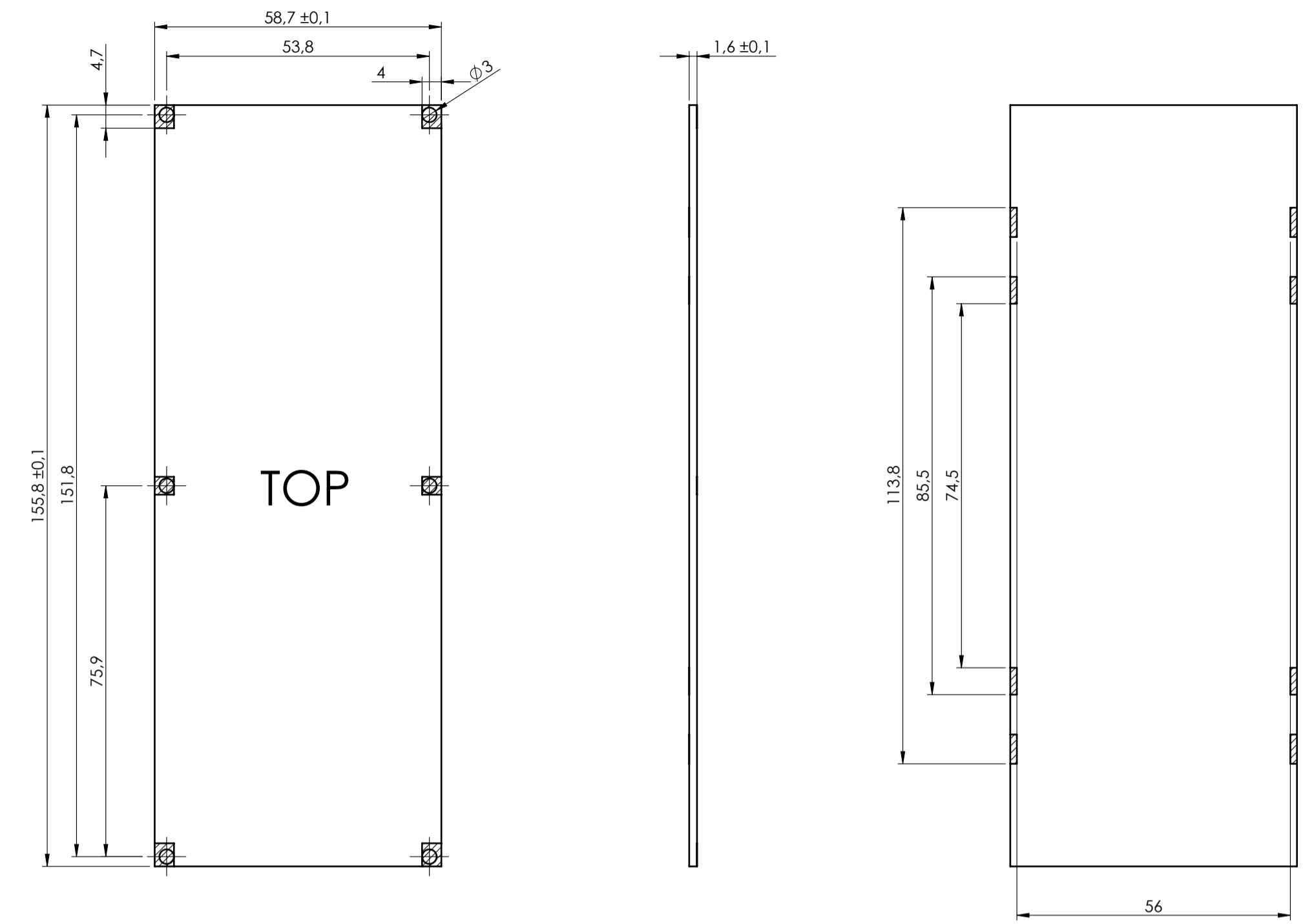

PCB C

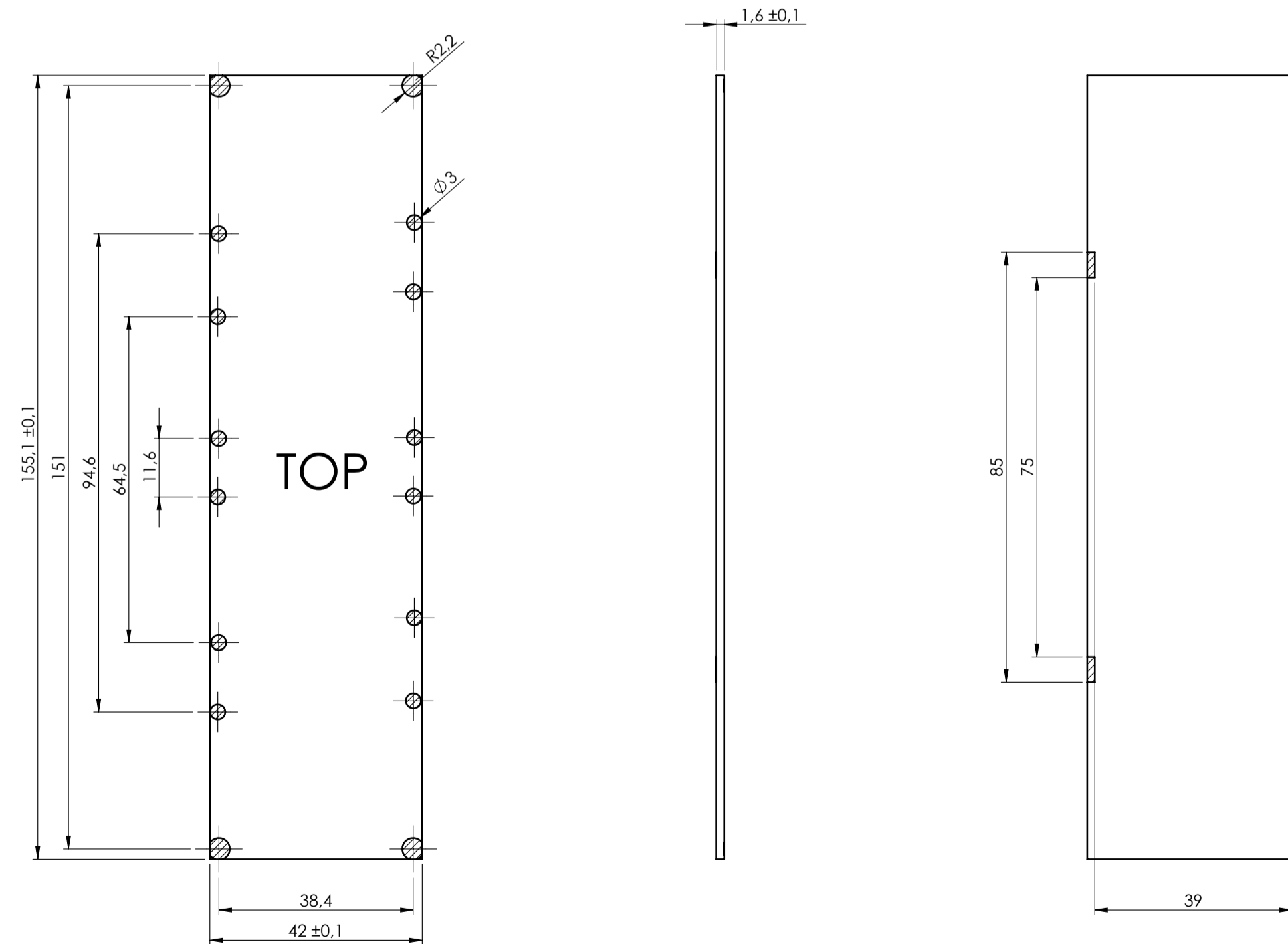

General Tolerance UNE EN 22768/1 Media (m)				Sheet:	
from 0.5 to 3 ± 0.1	from 3 to 6 ± 0.1	from 6 to 30 ± 0.2	from 30 to 120 ± 0.3	from 120 to 400 ± 0.5	PCB
Scale:	Drawn:	Checked:	Date:	Material:	Process:
1:1	M.S.	R.N.	26/07/2023		
Dimension in mm			Derived from:	Weight:	Cod. Mold:
				gr	--
Description:				Rev:	
KIT CONTENITORE MODULBOX ONE 9MH68 KIT ENCLOSURE MODULBOX ONE 9MH68				00 A1	
Drawing n°:				3_250_00173	
Italtironi enclosures for electronics italtironi.com					

NO COMPONENTS AREA